

Advantages

- ▶ Diverting valves are suitable for a long-lasting operation because of their particularly manufactured sealing and their flow characteristic.
- ▶ Small rotation torque of the valve allows motor actuator operating. In the same time it reduces possibility of valve blocking.
- ▶ The compact housing construction of the forging valve housings permits no damages when assembling and makes possible snaps. The valve construction allows simple assembly of the engines EMV 110..4680 without tool or opening the drive.
- ▶ Possible provisional exchange of the O-rings (Poz. 4) at the axle of the mixing valve can be accomplished also without omitting the water from the system. An additional O-ring (Poz. 4) is attached with the valve.

MIXING VALVE'S PARTS

DIVERT F3L

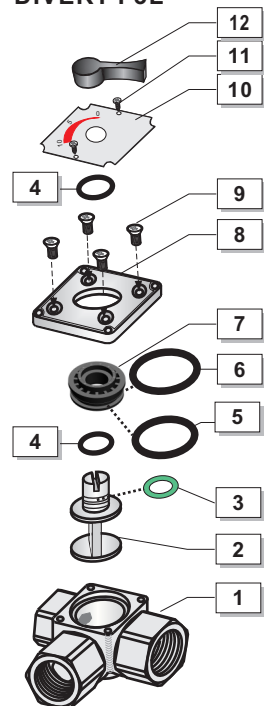

POS	NAME	PCS
1	Body Hot stamped CuZn39Pb3	1
2	Flap stem Brass CuZn39Pb3	1
3	O- seat 8.73x1,78 Viton FKM	1
4	O-ring 11.6x2.4 EPDM	2
5	O-ring 23.3x2.4 EPDM	2
6	O-Ring 27x2.5 EPDM	1
7	Insert RYTON R-4-200BL	1
8	Valves top alloy	1
9	Screw M5x10 DIN 965	4
10	Position plate Al	1
11	Screw 2.9x6.5 DIN 7981 BC	2
12	Handle of the valve PA	1

Spare O-Ring
(Position 4)
code: 500032

FIRŠT-ROTOTEHNIKA, s.p.,
Radegunda 54, 3330 Mozirje
tel: 03/ 898 35 00, fax: 03/ 898 35 35
Info@first.si, www.first.si

FIRST®

BRASS DIVERTING VALVES DIVERT F3L

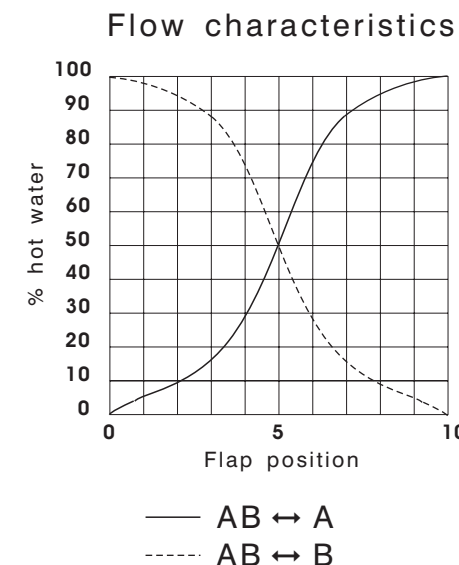
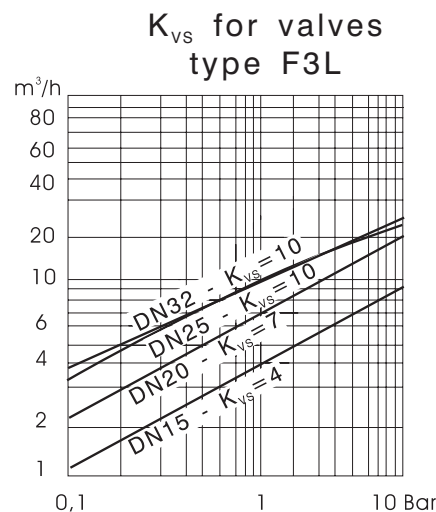

Technical data:

Max. medium temperature	110°C
Max. medium pressure	6 bar
Rotation angle	90°
Torque	0.5 Nm
Housing	stamped brass
Rotor	brass
Bearing	4x O-ring, EPDM
To be used with actuators	EMV 110..4680 ROTODIVERT

Diverting valves are used for controlling flowdirection in heating systems in which a certain leakage can be accepted and in which a defined flow characteristic is not required.

DIVERT F3L

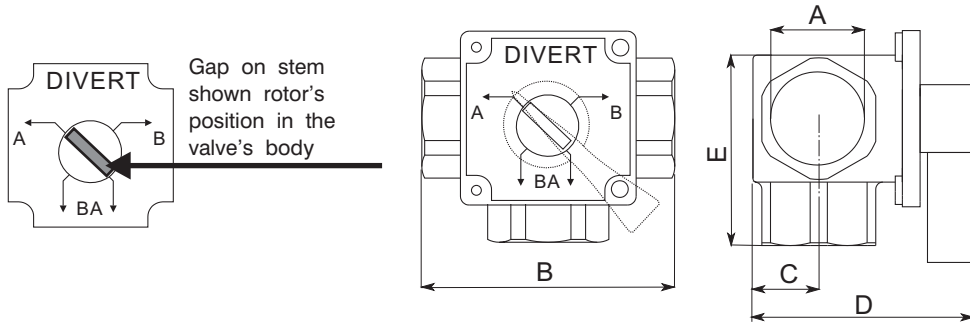

CODE	DN	A	B	C	D	E	K_{vs}	kg	
41004	1/2"	15	1/2"	72	18.5	64	54	4	0.63
41005	3/4"	20	3/4"	72	18.5	64	54	7	0.53
41006	1"	25	1"	90	24	69	69	10	0.66
41007	1 1/4"	32	1 1/4"	90	24	69	69	15	0.90

EXAMPLE 1

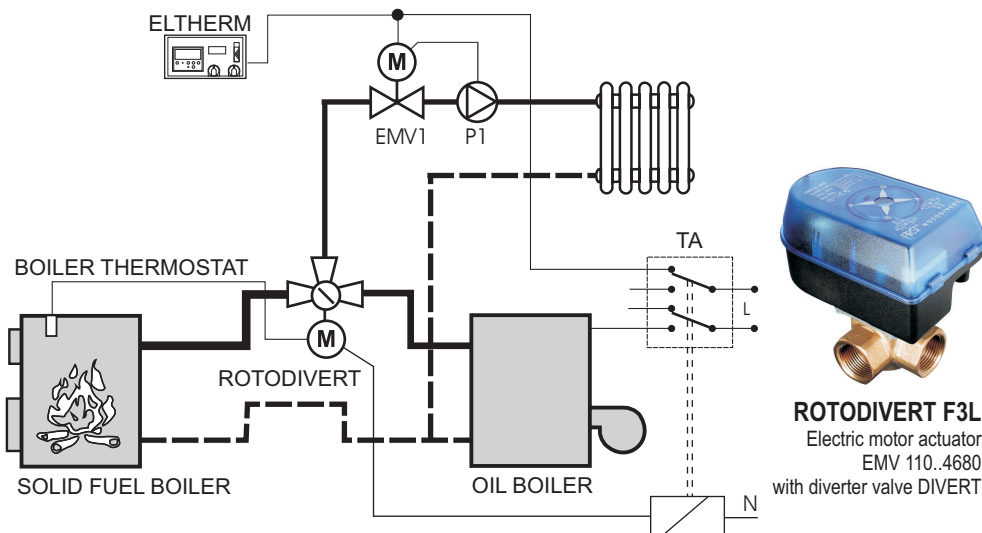

Diverter valve switches between two heating sources. This combination ensures utilisation of cheaper energy source. When this source is consumed, reversible valve switches to the second energy source and with limit switches, which are in the actuator, activates the second energy source. The flow through the pump is never completely closed by F3L reversible valve, therefore no pressure shocks appear.

EXAMPLE 2

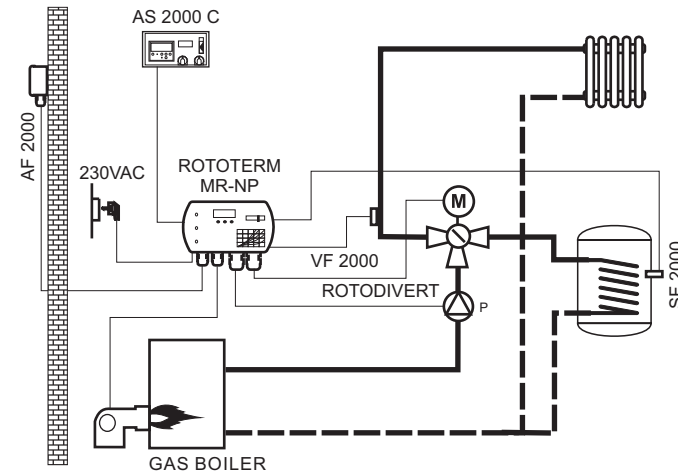

In combination with "ROTOTERM MR-NP" automatic control system of the house this separating valve enables heating of a residential unit and sanitary water with just one pump, where sanitary water has priority. The flow through the pump is never completely closed by ROTODIVERT diverter valve, therefore no pressure shocks appear.

EXAMPLE 3

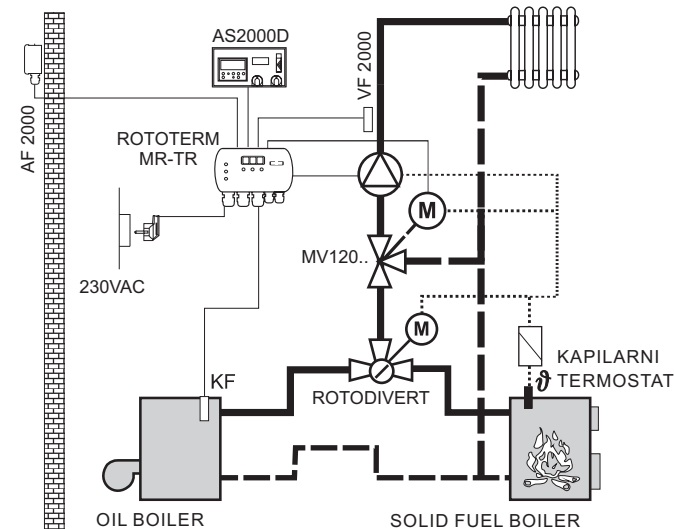

Diverter valve switches between two heating sources. This combination ensures utilisation of cheaper energy source. When this source is consumed, reversible valve switches to the second energy source and with limit switches, which are in the actuator, activates the second energy source. For heating regulation is used regulator ROTOTERM MR-TR.



IMPORTANT!

The safety valve must be installed in case of overheating of solid fuel boiler. Upper examples are only for showing the basic installation. To extend the long term performance of the motorised ball valve it is recommended that a strainer is situated prior to the valve. By installation must be observed to according to relevant local standards.