

S9000 - 2P

FIRST ELECTRIC ACTUATORS EMV 110

with Clip system for 2-way, 3-way and 6-way valves



2-POINT CONTROL	1 / 0	STOP AT END POSITIONS
-----------------	-------	-----------------------

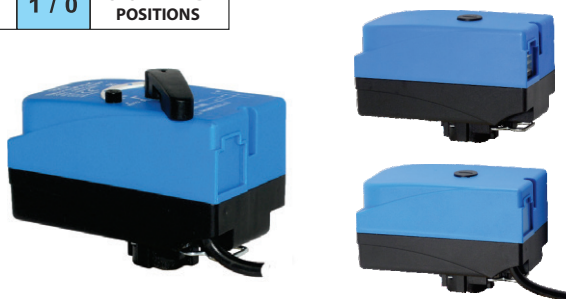

FIRST actuators EMV 110, series S9000 2P, are 2-point actuators designed for operating 2-way, 3-way and 6-way valves with clip system (DN 15 - DN 32).

- The FIRST S9000 2P actuators have defined direction of rotation (90° rotating angle).
- Actuators are available with cable or Molex connection with or without manual control handle.
- Recommended for diverting and on/off applications.

OPERATION

S9000 2P is an electric actuator designed for operating 2-way, 3-way and 6-way valves. Actuators are controlled by 2-point SPST signal built-in relay module. FIRST S9000 2P actuators allow high regulating accuracy and easy installation with one-click CLIP system.

Actuators are available in 230 V AC 50Hz or 24 V AC 50 Hz and are supplied with a 1m attached connection cable or Molex connector. Actuator can be manually operated with handle and button on the cover.

Actuators S9GV0 are recommended for diverting applications with FBV 230C valves from DN20 to DN 32 or FBV 330C valves and for on/off applications with FBV 200C valves from DN15 to DN32.

MAINTENANCE

Actuator requires no maintenance. The installation of suitable strainer is recommended.

TECHNICAL DATA: ACTUATOR

Control:	2-point SPST
Supply voltage:	230 VAC 50Hz / 24 VAC 50Hz
Rotation time:	20s/90°, 40s/90°, 55s/90°, 80s/90°, 110s/90°
Power consumption:	9 VA (operation), 7 VA (stand by relay on), 0 VA (stand by relay off)
Max. Torque:	5 Nm
Protection class:	II
Enclosure rating:	IP40 (Molex), IP44 (Cable connection), IP44 (specially sealed Molex cable)
Connection:	cable 1 m, 3 x 0,75 mm ² / Molex connector
Direction of rotation:	CW/CCW defined 90° angle
Manual operation:	with or without handle and button on the cover
Position indicator:	handle with position indicator / position indicator
Media temperature:	+2°C..+110°C (With optional SCA adaptor -15°C to +125°C, briefly up to +150°C)
Ambient temperature:	0°C..+55°C
Storage temperature:	-10°C..+70°C
Humidity:	0%..80% R.H. (non condensed)

INSTALLATION POSITION

Actuator can be installed only in one position.

S9GV0 with FBV 230C valves for diverting applications.

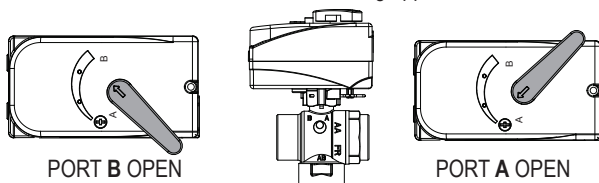

S99V0 with FBV 200C valves for on/off applications.

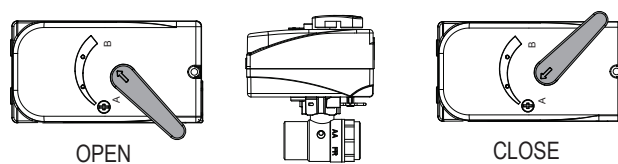

ELECTRICAL CONNECTION

2-point control SPST.

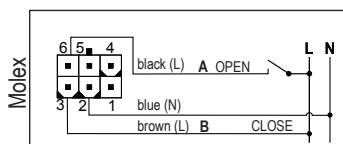
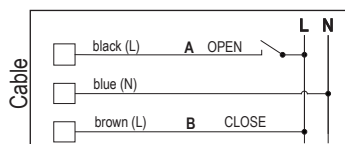

Optional: Potential free output S1.

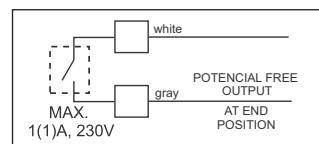

SUITABLE VALVES

FBV 230C



FBV 330C



FBV 200C



6-WAY VALVE



CLIP SYSTEM

Compact design of the valve allows easy assembling and disassembling. Clip system allows easy installation of the actuator on the valve body with single click, without any tools.



Available as zone unit:
S9000-230C

CE In accordance with PED, LVD, RoHS2, EMC



FIRST d.o.o.
Koroška cesta 56
SI-3320 Velenje
SLOVENIA

phone: +386 3 898 35 00
fax: +386 3 898 35 35
email: info@first.si
web: www.first.si

www.first.si
Let First be your first choice.



S9000 - 2P

FIRST ELECTRIC ACTUATORS EMV 110

with Clip system for 2-way, 3 way and 6-way valves

S9000 2P

Actuator with manual control handle - **S9GV0**

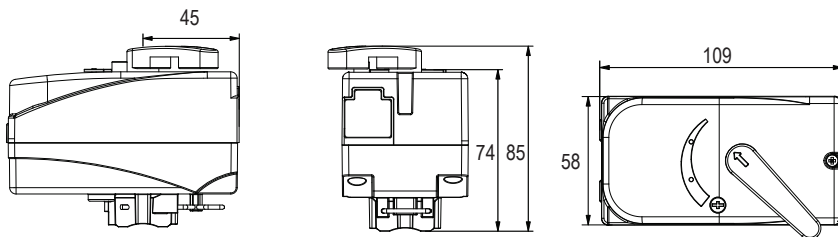

Actuator without manual control handle - **S99V0**

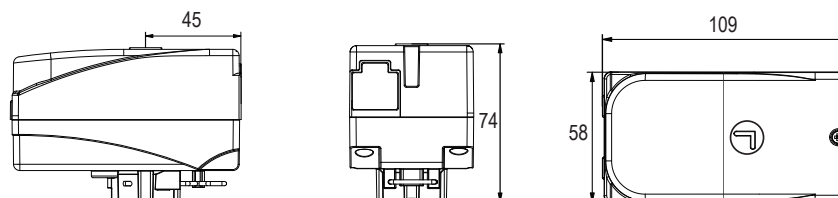

S9000 2P, for 3-way and 2-way valves (90° rotation)

Code	Type	Voltage	Rotation time	Control signal	Connection	Max. torque [Nm]	Weight [kg]	Price (€)
14009	S9GV0-M 2P	230 VAC 50 Hz	20s/90°	2-point SPST	Molex	5	0,33	
14010	S9GV0-K 2P	230 VAC 50 Hz	20s/90°	2-point SPST	Cable	5	0,48	
14017	S99V0-M 2P	230 VAC 50 Hz	20s/90°	2-point SPST	Molex	5	0,48	
14018	S99V0-K 2P	230 VAC 50 Hz	20s/90°	2-point SPST	Cable	5	0,33	

Installation examples

Actuator **S9GV0** with **FBV 200C** valves (on/off applications).

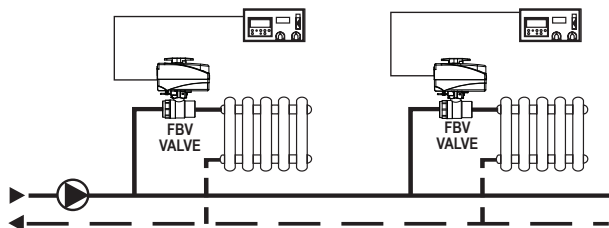

Actuator **S99V0** with **FBV 230C** valves.

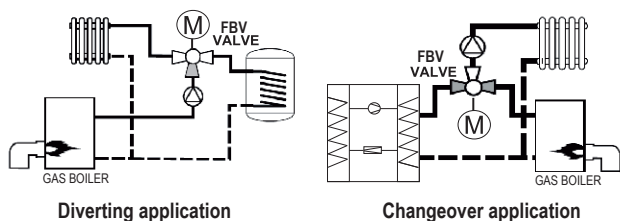

Features and options

- **Auxiliary switch:** one potential free auxiliary switch in the end position of the actuator is available as an option.
- **Power supply:** 230V 50Hz or 24V 50Hz
- **Connection:** Molex connector (IP40) and optional specially sealed Molex cable (IP44) or cable (3x0,75mm² l=1m) - (IP44).
- **Different running times:** 20s/90°, 40s/90°, 55s/90°, 80s/90°, 110s/90°.
- **Solar/cooling adapter:** Heat barrier for protection of the actuator in solar or cooling systems.
- **Manual control handle:** with or without manual control handle.

DIFFERENT OPTIONS

- Solar/ cooling adapter.



- Special Molex IP44 connector



- Without manual control handle



- With cable connection

